

TREES 179 – 178 ARE TO BE REMOVED FOR CONSTRUCTION WORKS ASSOCIATED WITH ACCESS TO LOT 6. THESE TREES ARE NON-NATIVE AND THEREFORE DO NOT REQUIRE NATIVE VEGETATION OFFSETS.

ADVERTISED

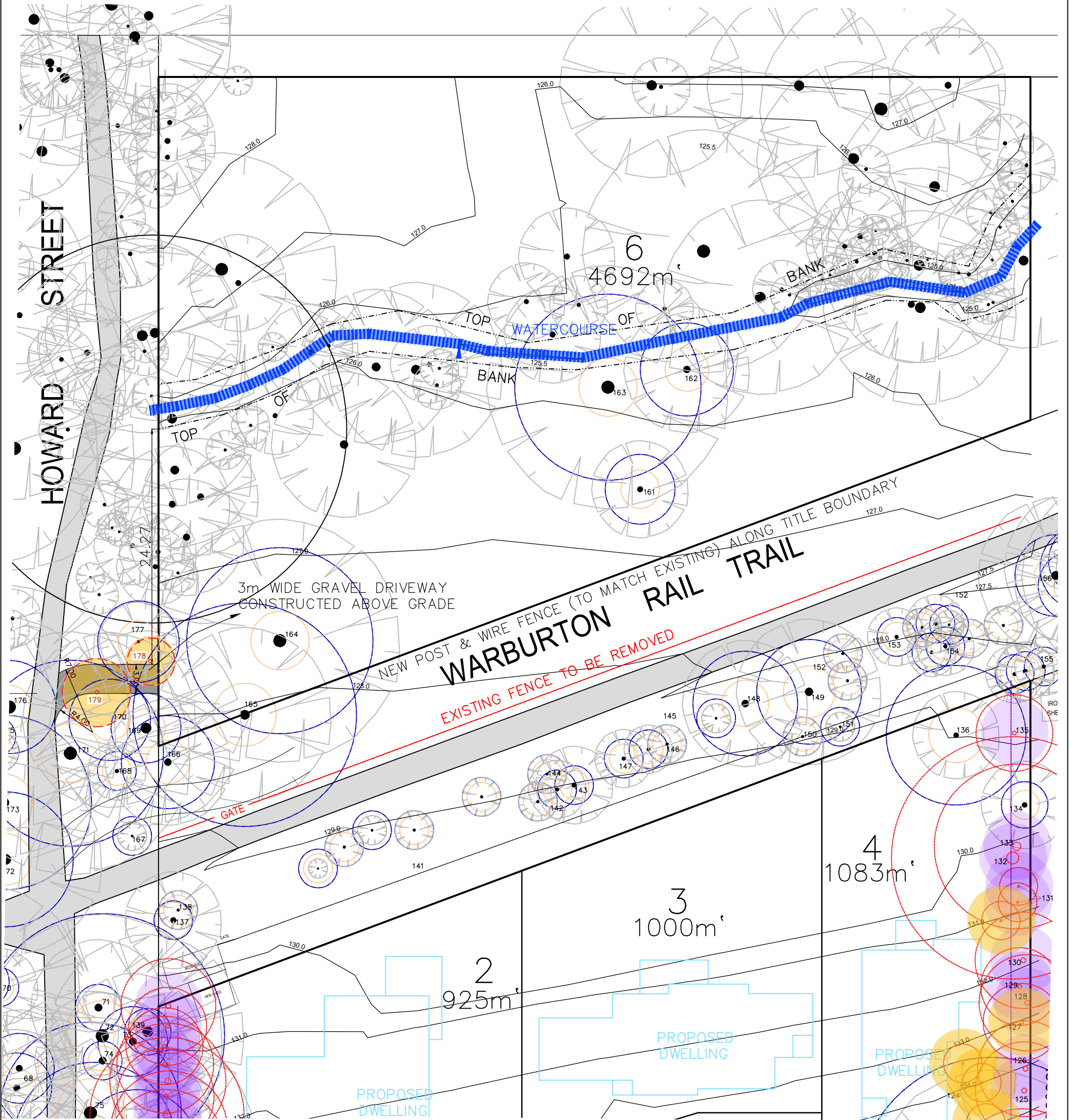

TREE TO BE REMOVED

EXEMPT FROM OFFSETTING UNDER CL. 52.17 (PLANTED OR NON-NATIVE VEGETATION)

EXEMPT FROM OFFSETTING UNDER BUSHFIRE PROTECTION EXEMPTION RULES (CL. 52.12)

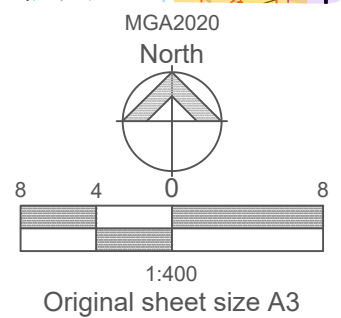

Millar & Merrigan authorize the use of this drawing only for the purpose described by the status stamp shown below. This drawing should be read in conjunction with all relevant contracts, specifications, reports & drawings.
© Millar & Merrigan Pty. Ltd.

Millar | Merrigan

Land Development Consultants

Civil Engineering
Land Surveying
Landscape Architecture
Project Management
Town Planning
Urban Design
SAI GLOBAL Quality ISO 9001

Millar & Merrigan Pty Ltd ACN 005 541 668
Metro 2/126 Merrindale Drive, Croydon 3136
Regional 156 Commercial Road, Morwell 3840
Mail PO Box 247 Croydon, Victoria 3136
M(03) 8720 9500 R(03) 5134 8611
www.millarmerrigan.com.au
survey@millarmerrigan.com.au

VEGETATION PLAN
5 SEYMOUR STREET, SEVILLE

YARRA RANGES COUNCIL

26538NVP

VERSION 1
SHEET 1 OF 2

FOR APPROVAL

The majority of vegetation within Lots 1 –5 are exempt from offsetting requirements under the bushfire exemption rule (within 10m of existing dwelling and within 2m of an existing dwelling).

All other vegetation is non-native (Australian natives) or of exotic origin therefore also exempt from offsetting requirements. Refer to associated arborist report for details on species type.

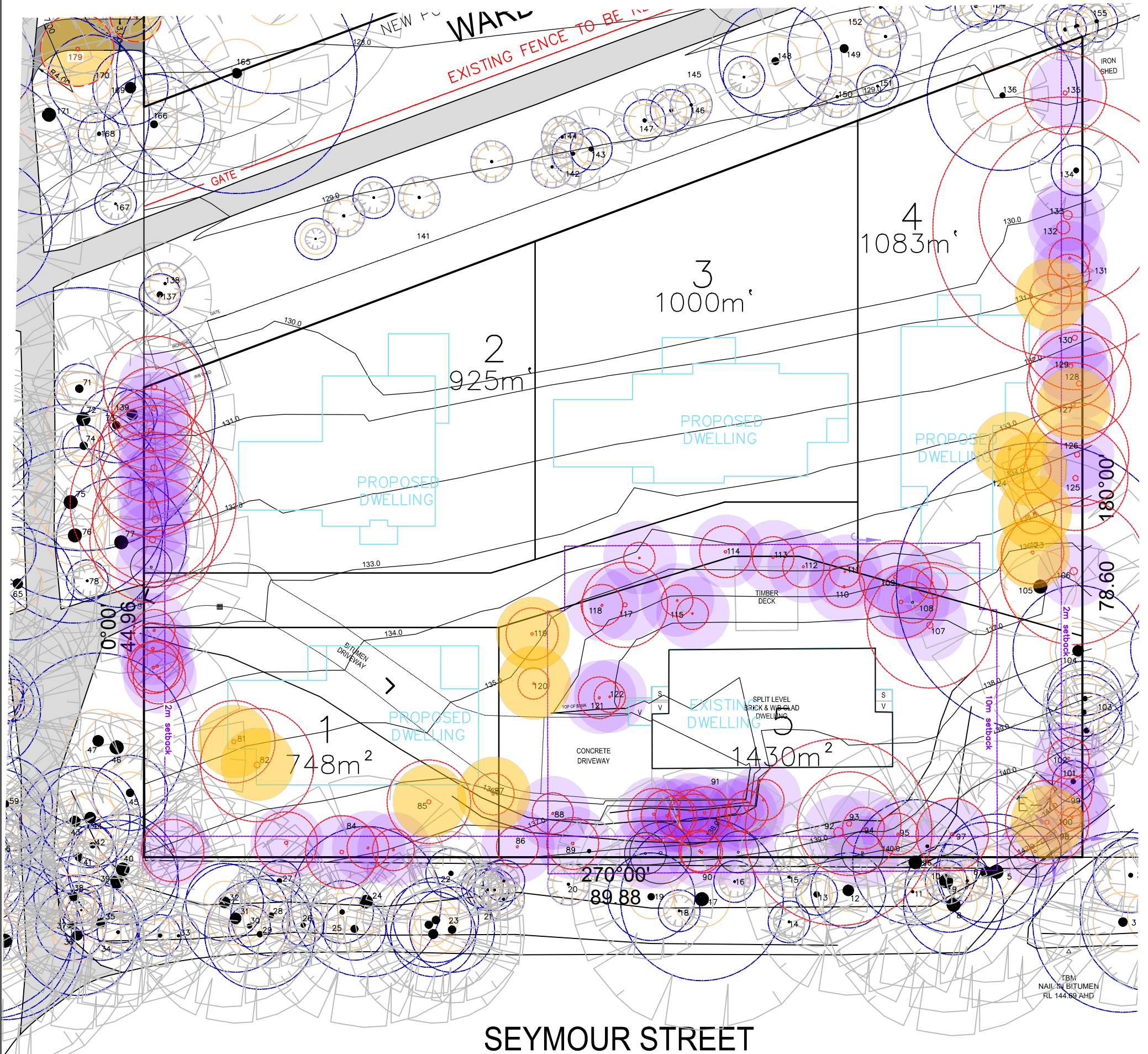

SEYMOUR STREET

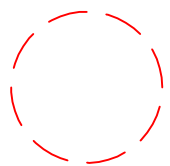

TREE TO BE REMOVED

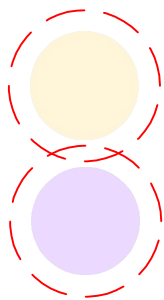

EXEMPT FROM OFFSETTING UNDER CL. 52.17 (PLANTED OR NON-NATIVE VEGETATION)

EXEMPT FROM OFFSETTING UNDER BUSHFIRE PROTECTION EXEMPTION RULES (CL. 52.12)

MGA2020

North

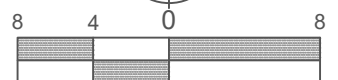

1:400

Original sheet size A3

Millar & Merrigan authorize the use of this drawing only for the purpose described by the status stamp shown below. This drawing should be read in conjunction with all relevant contracts, specifications, reports & drawings.
© Millar & Merrigan Pty. Ltd.

Millar | Merrigan

Land Development Consultants

Civil Engineering
Land Surveying
Landscape Architecture
Project Management
Town Planning
Urban Design
SAI GLOBAL Quality ISO 9001

Millar & Merrigan Pty Ltd ACN 005 541 668
Metro 2/126 Merrindale Drive, Croydon 3136
Regional 156 Commercial Road, Morwell 3840
Mail PO Box 247 Croydon, Victoria 3136
M(03) 8720 9500 R(03) 5134 8611
www.millarmerrigan.com.au
survey@millarmerrigan.com.au

VEGETATION PLAN

5 SEYMOUR STREET, SEVILLE

YARRA RANGES COUNCIL

26538NVP

VERSION 1

SHEET 2 OF 2

FOR APPROVAL